



COSMO-BETHEL PARK FACILITIES

- | | | |
|--|---|---|
| <p>40 Acres
 Dr. Charles A. Leech Shelter - Reservable
 Lights
 Electric Service:
 220 Volt Outlet (1)
 110 Volt Quad Outlets (9)
 2 Double BBQ Grill (ADA)
 Drinking Fountain w/ Jug Filler (ADA)
 Cosmo-Bethel Tennis Shelter - Non-Reservable
 Lights
 Electric Service:
 220 Volt Outlet (1)
 110 Volt Quad Outlets (4)
 Drinking Fountain w/ Jug Filler (ADA)</p> | <p>J. W. Ficklin Shelter - Reservable
 Lights
 Electric Service:
 220 Volt Outlet (1)
 110 Volt Quad Outlets (6)
 1 Double BBQ Grill (ADA)
 Drinking Fountain w/ Jug Filler (ADA)
 Restrooms (open year round)
 12 - Tennis courts, 8 lighted
 (Includes 4 tennis courts owned
 by Columbia Public Schools)
 1 - Baseball/Softball Practice Field
 Cosmo-Bethel Lake 7.6 acres
 0.46 mile Gravel Lake Trail</p> | <p>2 - Horseshoe Pits
 Open Field Area
 Playground
 1 - Volleyball Court (Sand)
 Parking
 186 Standard Spaces,
 10 ADA Spaces</p> |
|--|---|---|

COSMO-BETHEL PARK

4500 Bethel Street

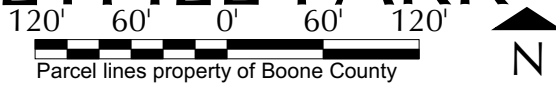

Parcel lines property of Boone County

